

SPECIAL FEATURES

Continuous Duty
"I" Section Extension to Facilitate smaller flange sizes suitable for Anti Corrosive Protection.

SPECIFICATIONS

Range: -1 kg/cm² to 100 kg/cm²
 Process Temperature: -40°C to 200°C without PTFE Lined
 Instrument Connection: 1/2"NPT(F)
 Process Connection: Flange (as per DIN/BS/ANSI/JIS) 125-250 AARH
 Fill Fluid: Silicon Oil-DC 200
 Diaphragm: AISI 316L SS
 Top Chamber: AISI 316 SS
 Bottom Chamber("I"Section): AISI 316 SS Flange (As per DIN/BS/ANSI/JIS)
 Nut,Bolts: AISI 304 SS
 Sealing Gasket: PTFE



APPLICATIONS

Diaphragm seals are provided in the Instrument like Pressure Gauges ,Switches, Transmitters in order to isolate the sensing element from the main service due to It's Corrosive ,Viscous and Sedimented nature and to avoid clogging and solidification. This can be widely used with anti corrosive treatment/ protection & various flanged sizes.

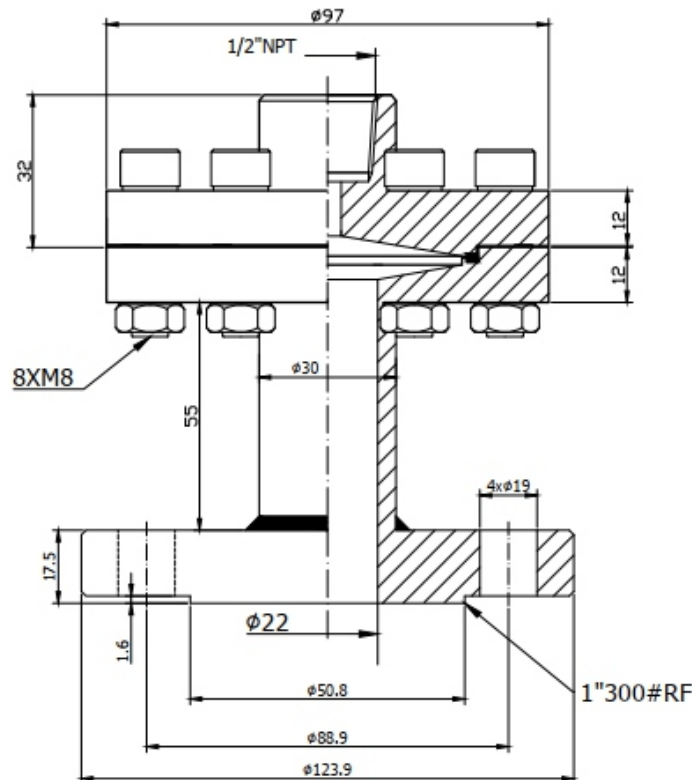

Example

HOW TO ORDER

BASIC MODEL

RANGE

S21 -1 to 0 kg/cm² & 0 to 100 kg/cm² **S22** 100 kg/cm² to 250 kg/cm²

INSTRUMENT CONNECTION

VP 3/8"BSP(F) **VL** 1/2"BSP(F) **VM** 1/2"NPT(F)(Standard)

TOP CHAMBER

XW AISI 304 SS (Standard) **YA** AISI SS316L SS **XY** AISI 316 SS **YC** CARBON STEEL

DIAPHRAGM

UJ AISI 316L SS (Standard) **UL** HASTELLOY 'C276' **UR** TITANIUM **UW** INCONEL 600
UM MONEL **UP** SILVER* **UQ** TANTALUM **UN** SUPER DUPLEX

SEALING GASKET

VI PTFE (Standard) **YR** METAL **YQ** Inconel Silver Plate for Max 400°C (High Temp.Oil)

BOTTOM CHAMBER (I SECTION)

TK AISI 304 SS **TT** HASTELLOY 'C'
TM AISI 316 SS(Standard) **TN** CARBON STEEL
TL AISI 316L SS **TZ** PVC*
UH TITANIUM **UA** PVDF*
TX MONEL **TY** POLYPROPELENE*

MOC OF BOTTOM CHAMBER	PRESSURE V/S TEMPERATURE					
	20°C	40°C	60°C	80°C	100°C	120°C
PVDF	10 kg/cm ²	10 kg/cm ²	10 kg/cm ²	7 kg/cm ²	4 kg/cm ²	2 kg/cm ²
PP	10 kg/cm ²	10 kg/cm ²	6 kg/cm ²	4 kg/cm ²	1 kg/cm ²	NA
PVC	10 kg/cm ²	10 kg/cm ²	4 kg/cm ²	1 kg/cm ²	NA	NA

PROCESS CONNECTION

As per DIN / BS / ANSI / JIS (Select Code from Flange Table.Refer Page No.25 & 26)

NUTS-BOLTS

XQ AISI 304SS **XR** AISI 316SS

PROTECTION ON WETTED PARTS

VS PTFE LINING ON BOTTOM CHAMBER("I"SECTION) -2mm THICK (Max.Up to 150°C)
VV PTFE PROTECTION FOR DIAPHRAGM (Max.Up to 150°C max up to 100 bar)
VZ PTFE COATING ON DIAPHRAGM (Max.Up to 315°C)

FILLING LIQUID

US FLUROLUBE 4.2 [-45 to 175°C] **UX** SILICON DC 200[-40 to 205°C](Standard) **VB** SYLTHERM XLT [-100 to 260°C]
UT FLUROLUBE 6.3 [-40 to 235°C] **UY** SILICON DC 704 [10 to 337°C] **VC** HALOCARBON OIL*
UU FLUROLUBE FS-5 [-28 to 148°C] **UZ** SILICON DC 710 [7 to 371°C] **VD** LRS9 [-40 to 400°C]
UV FOOD GRADE OIL [-20 to 140°C] **VA** SYLTHERM 800 [-40 to 315°C]

REMOTE MOUNTING (With Capillary of Max. Up to 15 Mtrs.)

SPECIFY IN METERS (e.g 1.5=1.5 METERS 2.0=2 METERS)

CAPILLARY

PE AISI 304 SS **PG** AISI 316 SS

CAPILLARY COVERED WITH ARMOUR (Applicable with PE or PG if selected)

PF AISI 304 SS **PH** AISI 316 SS **PI** PVC

OTHER OPTIONS

TB HELIUM LEAK TEST **TC** DRY SEAL ONLY WITHOUT INSTRUMENT **GH** MATERIAL TEST CERTIFICATE*

Ordering Example: **D-08-XXX-XX-XX-XX-XX-XX-XX-XX-XX-XX-3 Mtr-XX-XX-XX**