

SPECIAL FEATURES

Curved Type Polycarbonate Lens
 Maximum Drag Pointer With Key
 0.39" (10mm) Pointer Arm
 DIN Case & American Bayonet Case
 Versions For Options

SPECIFICATIONS

Material: Polycarbonate (PC)
 Type: Curved Type
 Pointer: Aluminum Red Painted With Key
 Pointer Arm: 0.39" (10mm) Customer Can Cut As Request



STANDARD VERSION NOMINAL SIZE

NOMINAL SIZE: 2.5" (63mm) & 4" (100mm)

DIN CASE TYPE

AMERICAN CASE TYPE

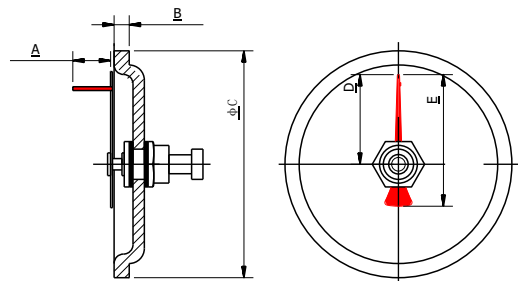
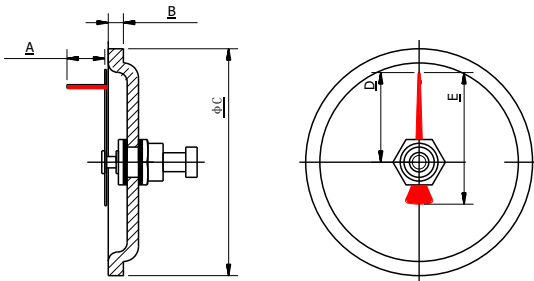

NS	A	B	φC	D	E	Weight (lbs)
2.5"	0.39"	0.16"	2.36"	0.9"	1.36"	0.05
4"	0.39"	0.16"	3.74"	1.52"	2.24"	0.11

NS	A	B	φC	D	E	Weight (lbs)
2.5"	0.39"	0.16"	2.52"	0.9"	1.36"	0.05
4"	0.39"	0.16"	4.13"	1.52"	2.24"	0.11